

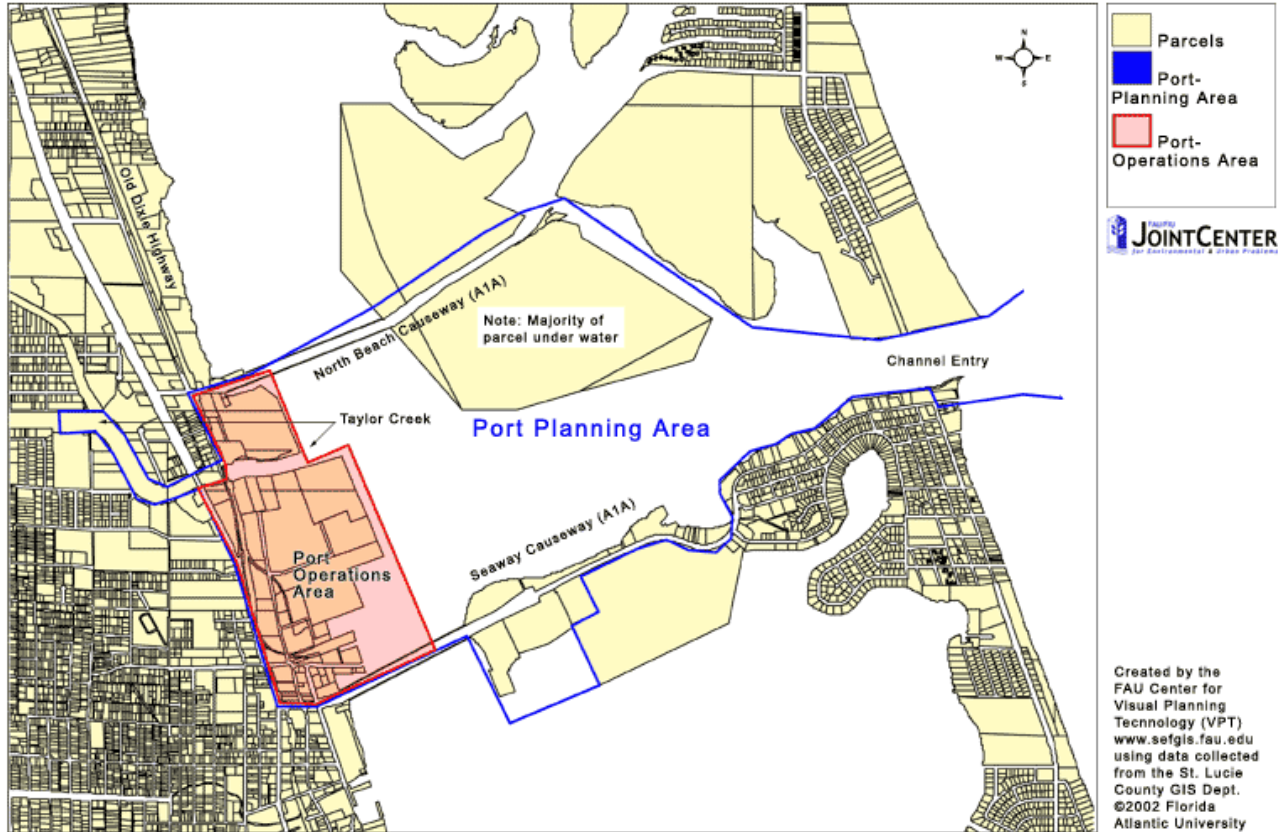

MAP OF PORT OF FORT PIERCE PLANNING AND OPERATIONS AREAS

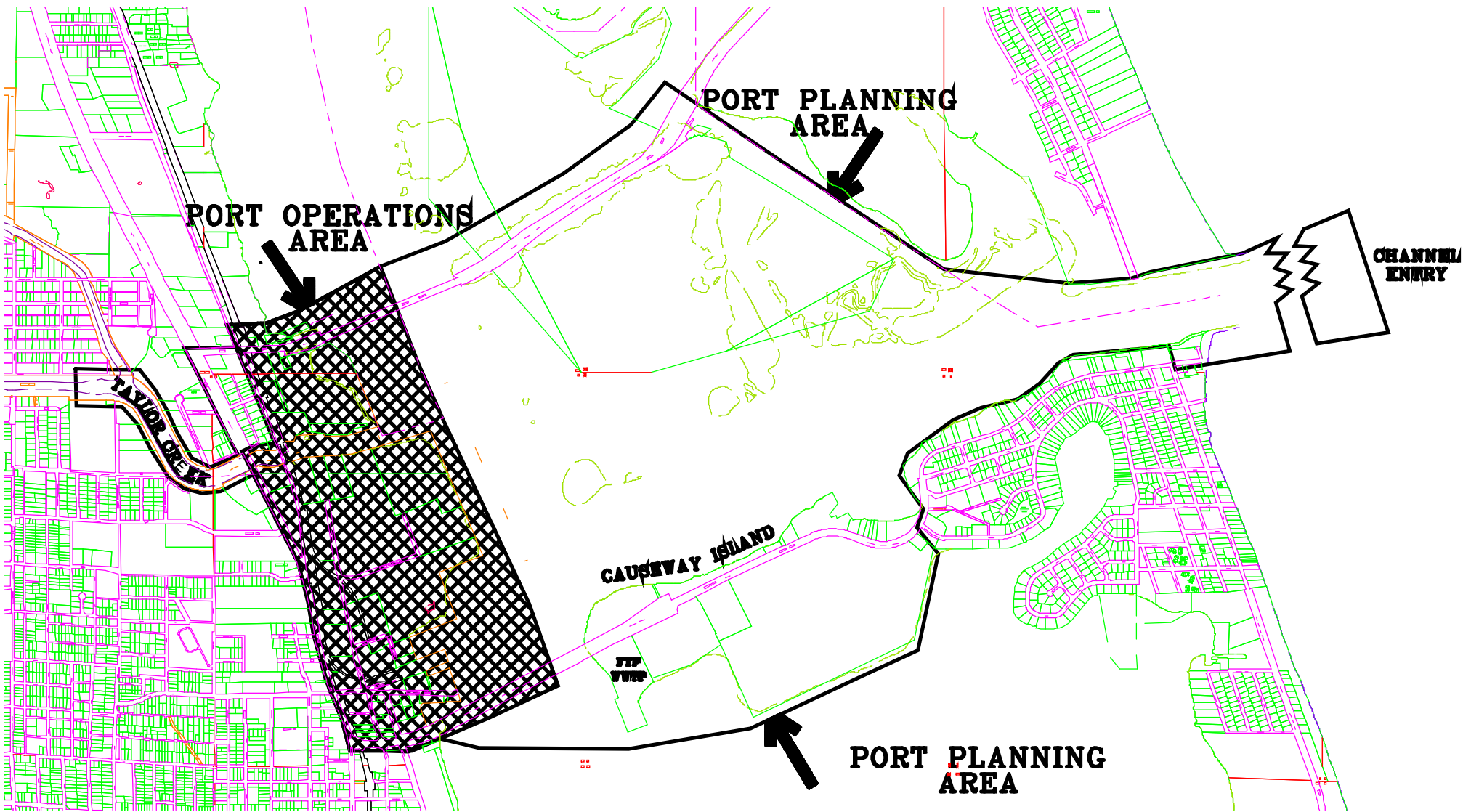



F ggr y cvgt 'Rqt w'lp 'Hqtkf c

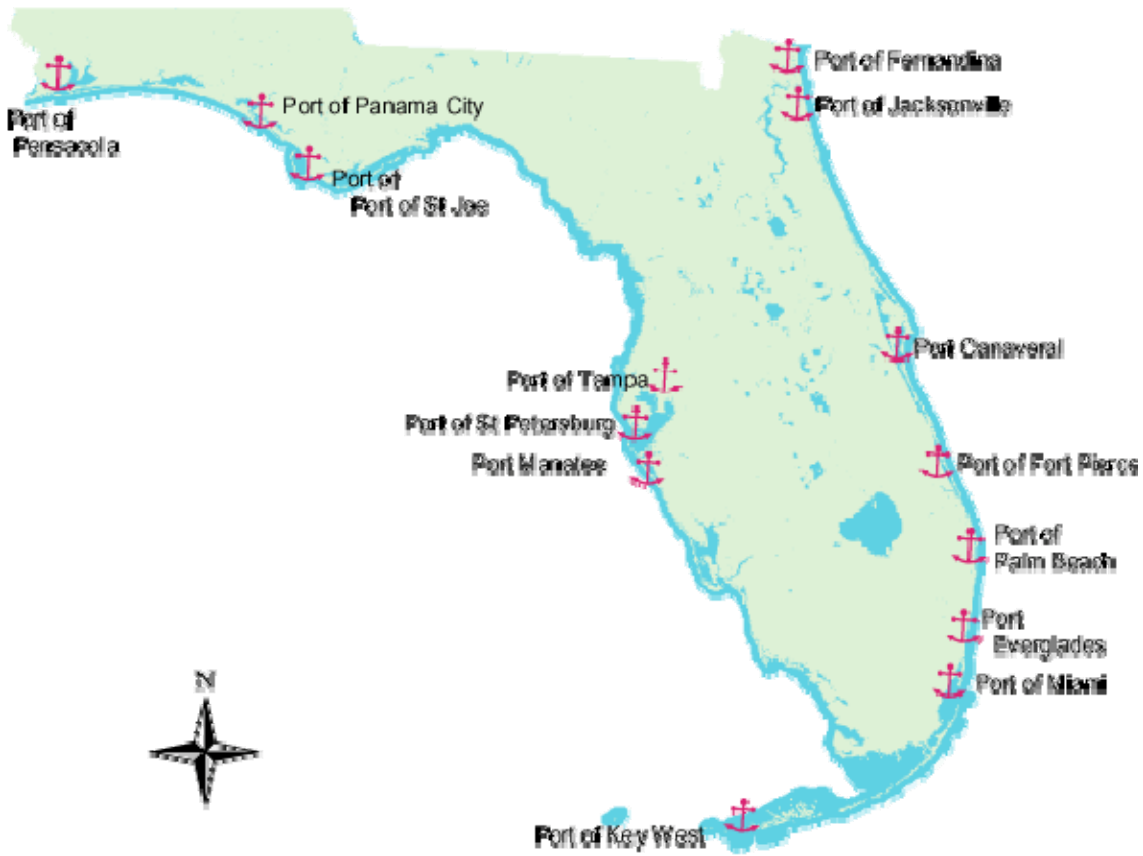

Legend

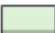
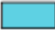
-  Ports
-  State of Florida
-  Water



St. Lucie County

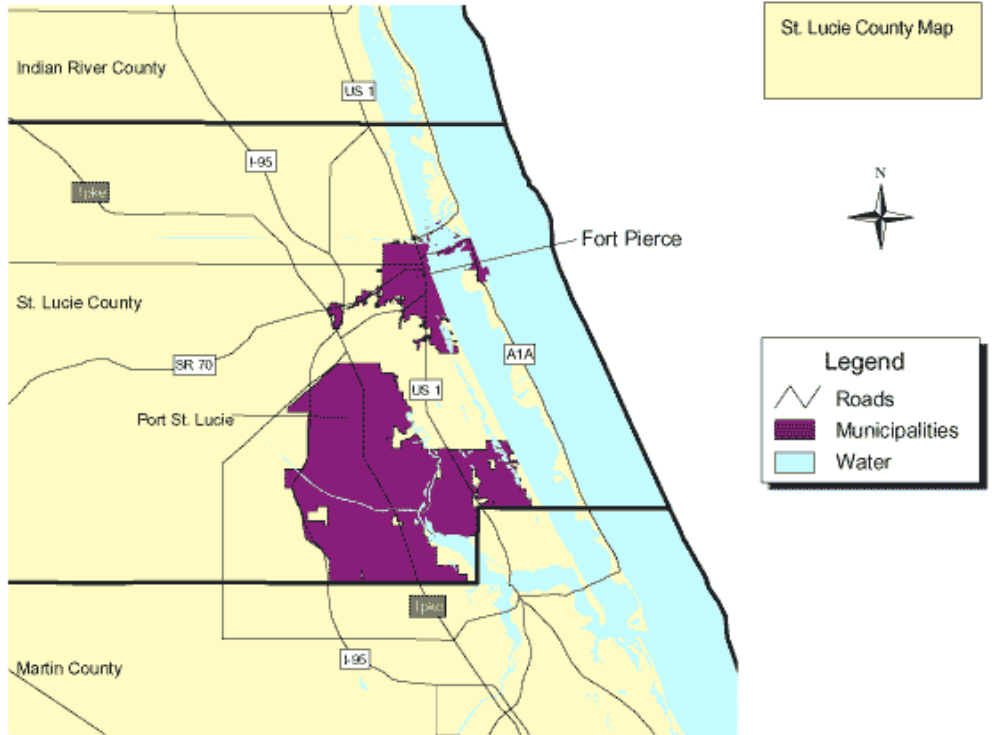

Copyright 2001
St. Lucie County



Port Planning Area

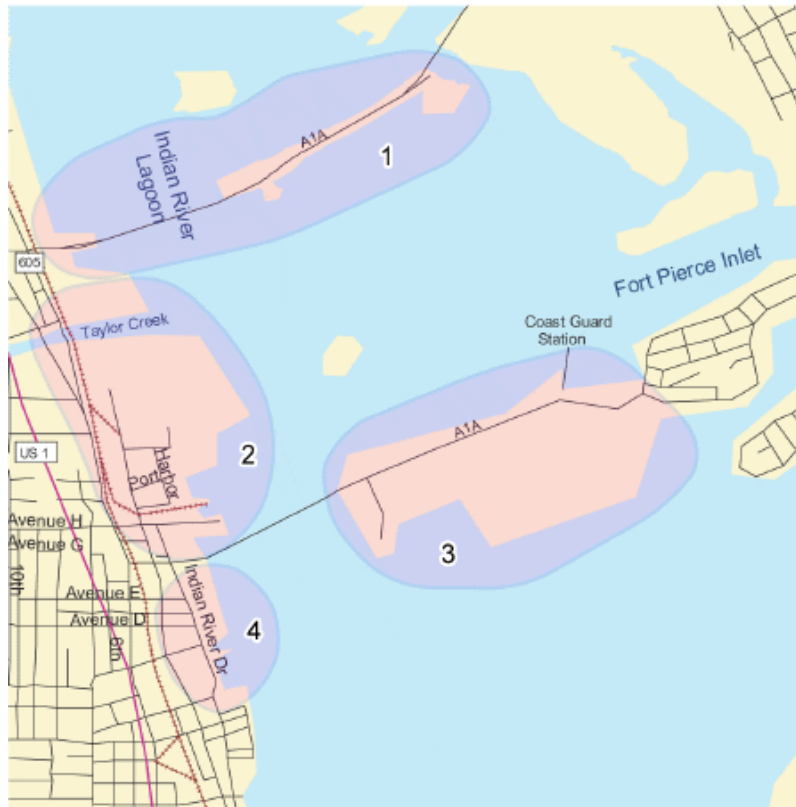

Port Planning Area



Legend

- Roads
- Railway
- Ft. Pierce Area
- Study Area
- Water

Copyright 2001
St. Lucie County













Aerial Image of Port of Fort Pierce



Copyright 2001
St. Lucie County



Port of Ft. Pierce 1996 Charrette Renditions

 <p>Berth, Phase 1</p>	 <p>Bird's Eye view of port with one alternative development pattern.</p>	 <p>Wharf-side elevation and Harbor Street Elevation of Industrial Buildings</p>
 <p>Example of Industrial Building</p>	 <p>Artist Rendition of End of Fisherman's Wharf; Moby Marine on Right Today</p>	 <p>Detail of Hypothetical Gazebo</p>
 <p>Harbor street improved, facing south towards new port authority building, Hypothetical on Bell Property</p>	 <p>New North Port Entrance</p>	 <p>Port of Fort Pierce 1996 Charrette, Charrette Plan for the Port & its Environs Dover-Kohl</p>
 <p>Hypothetical Taylor Creek, Hotel and mixed use buildings fronting park and public waterfront, Harbour point park today (vacant)</p>		